

# CCA Hubbell Street Galleries - 151 Hubbell Street

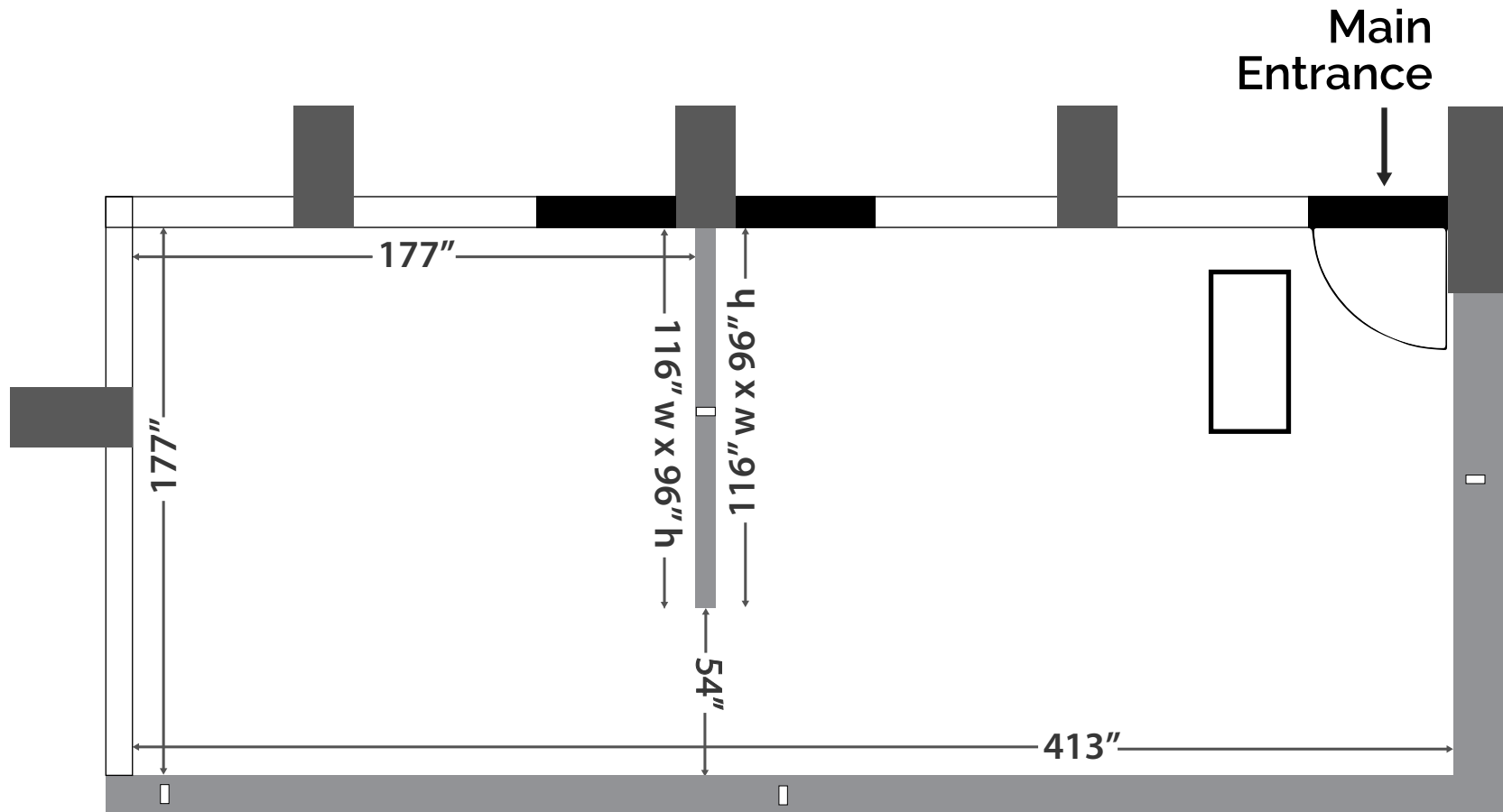

- 0.25"-plywood-backed walls
- concrete pillars
- windows
- doors
- desk
- outlets

## Notes:

track lighting: ~139" from floor

doors: 41" w x 95" h

ceiling: 204" from floor

windows: 50-57.5" w x 82-92.5" h

(contact exhibitions@cca.edu for exact measurements)